

ALPOLIC®/fr MATERIALS

MITSUBISHI PLASTICS COMPOSITES AMERICA, INC.

natural metals – copper

ALPOLIC®/fr Copper Metal Composite Material finish features a natural Copper surface that evolves and weathers to a rich patina, adding character and depth to any building facade.

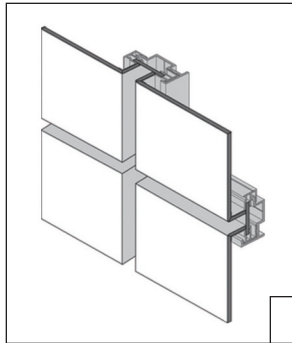

CONSTRUCTION INFORMATION

PROJECT: Ceridian Corporate Headquarters

ARCHITECT: Hammel, Green &
Abrahamson, Inc.

PRODUCT: ALPOLIC® Copper



GENERAL INFORMATION

Our Natural Metals Series is simply dazzling in both appearance and performance. It features the same flatness and workability of an aluminum composite material (ACM), but with the metal surface of your choice. Each 4mm metal panel is available in a fire resistant core.



COPPER
4-8C12

ALPOLIC® /fr copper

INTERIOR AND EXTERIOR SURFACING
INTERIOR AND EXTERIOR SIGNAGE

SURFACE TREATMENT

ALPOLIC®/fr Copper Composite Material (CCM) is created by sandwiching two thin layers of copper around a polyethylene core. The genuine surface of copper will weather over time and turn to a classic patina green.

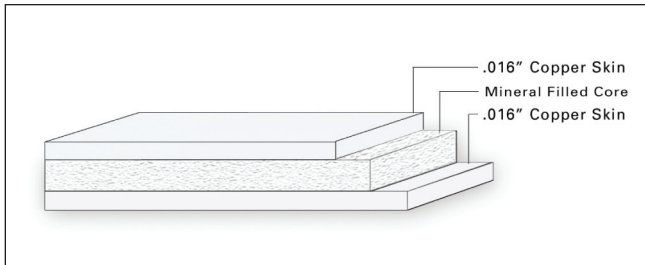

STANDARD PANEL SIZE

Standard size is 38" x 146" (965mm x 3708mm) in 30 piece crates. Custom lengths and thickness available. Please contact ALPOLIC® Customer Service for current available stock and additional information.

FINISH TOLERANCE

Finish color of natural metal cannot be controlled and some variation should be expected.

PRODUCT TOLERANCE

Width: $\pm 0.08"$ (2mm)
Length: $\pm 0.16"$ (4mm)
Thickness: $4\text{mm} \pm 0.008"$ (0.2mm)
Bow: maximum 0.5% of length and/or width
Squareness: maximum 0.2" (5mm)
Peel Strength: >22 in lb/in (ASTM D1781)

ALPOLIC® material is trimmed and squared with cut edges to offer the best panel edge conditions in the industry.

WARRANTY

Standard panel warranty: 10 Year
Finish warranty: Not Applicable
Call ALPOLIC® Customer Service for exclusions and warranty details.

PRODUCT NOTES

- Copper needs to be isolated from aluminum and other dissimilar metals to avoid galvanic corrosion.
- Panels should be stored flat in a dry, indoor environment.
- Protective film should be removed from panels soon after installation.
- Please refer to CCM Fabrication Manual for routing and fabrication recommendations.
- Crating fees apply to orders for less than standard piece crate.

FOR TECHNICAL INFORMATION, PLEASE
CALL 1.800.422.7270

U.S. HEADQUARTERS

 MITSUBISHI PLASTICS COMPOSITES AMERICA, INC.

401 Volvo Parkway, Chesapeake, VA 23320

Telephone: 800-422-7270, Facsimile: 757-436-1896

www.alpolic-northamerica.com e-mail: info@alpolic.com